

S6ASS2020/199

focusing lens for standard laser at 266 nm

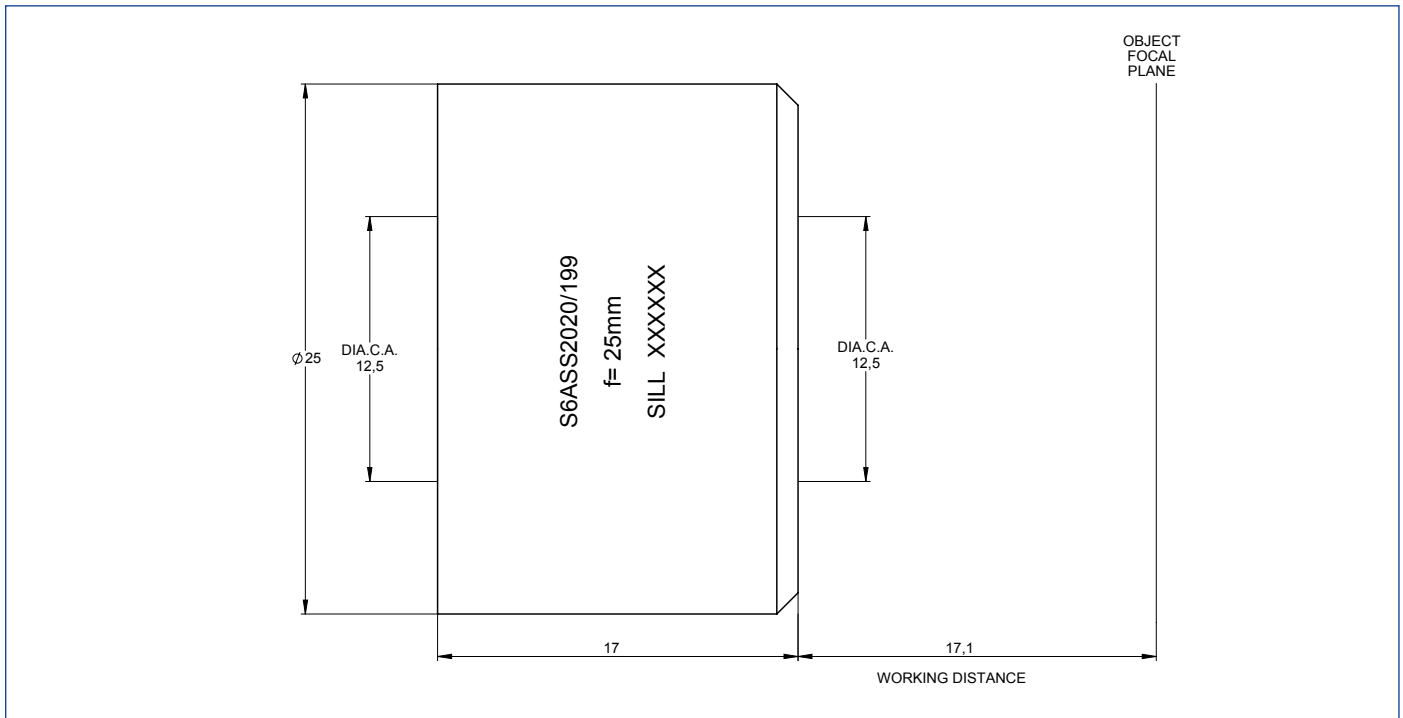

outline drawing

specifications

article number	S6ASS2020/199	spot radius [μm] ³⁾	0.70
design wavelength [nm]	266	LIDT (coating) [J/cm^2]	5.0 (1ns pulse at 50Hz)
effective focal length [mm]	24.0	total transmission [%]	98
working distance [mm]	17.1	total number of lenses	3
clear input aperture [mm]	12.5	lens material	fused silica
clear output aperture [mm]	12.5	diameter [mm]	25
max. input beam diameter [mm]	10.5	length [mm]	17.0
wavefront error ¹⁾	$< \lambda/10$ for $1/e^2$ diameter ²⁾ of 9.0	weight [kg]	not yet weighted

¹⁾ Wavefront error peak to valley on axis proved by design

²⁾ beam diameter vignettted at $1/e^2$

³⁾ spot radius in μm at 86% level for a Gaussian laser beam ($M^2=1$), with 9.0 mm diameter at $1/e^2$, clipped at $1/e^2$

LIDT = Laser Induced Damage Threshold, valid for the coating at design wavelength and gaussian intensity profil